

M830

Screen Tester Product Manual

YCX YUCHENGXING
宇 | 成 | 兴 | 科 | 技



Shenzhen Yuchengxing Technology Co., Ltd.
4th Floor, Building 10, Jinxiu Science Park, Longhua
District, Shenzhen Service
Hotline: 0755-23221950

Pictures are for reference only, the appearance is subject to the actual product.

Table of contents

| | | |
|-------------|---|-----------|
| 1. | Overview | 3 |
| 1.1 | Product advantages | 3 |
| 1.2 | Main function of the product | 3 |
| 2.1 | Key Description | 4 |
| 2.2 | Connection diagram | 4 |
| 3. | M830 tester | 5 |
| 4. | Screen display test | 6 |
| 5. | Touch line test | 7 |
| 6. | 3D-Touch function test | 8 |
| 7. | Screen brightness cycle function | 9 |
| 8. | Original screen original color repair | 10 |
| 9. | App online upgrade function | 11 |
| 10. | Product specifications and packaging | 12 |
| 11.1 | Warranty and non -warranty regulations | 13 |
| 11.2 | Precautions | 13 |

1.Overview



1.1 Product advantages:

- Support the assembly of various mobile phone screens, including OLED screens, TFT screens, original screens, assembly screens, compressed screens, etc.;
- The built-in display screen of the product, intuitively and clearly know the test situation;
- The product built-in voltage current collection, real-time monitoring screen power consumption;
- Automatic recognition of the screen model;
- Test box built-in multiple over flowing voltage monitoring;
- Support app online upgrade;
- The test box is small in size and is suitable for various operating environments;
- The screen model is complete, and the update speed is fast.

1.2 Main function of the product:

- Support mobile models: Iphone, Samsung, Huawei, Honor, OPPO, vivo, Xiaomi and other models
- Show test: Support manual or automatic switch test picture
- Touch test: support touch drawing line test
- 3D-Touch test: support the 3D-Touch function of the full screen at any location (iPhone 6s, 6SPlus, 7G, 7plus, 8G, 8Plus, X, XS, XS MAX screens supported by hardware 3D-TOUCH function)
- Apple original color repair function
- LCD IC model reading
- Software upgrade: Support app online upgrade

2.1 Key Description:



- | | | | |
|------------------|------------------------------------|--|--|
| ① LCM switch | ② Upper key | ③ Turn key | ④ Ground wire |
| ⑤ SD card | ⑥ Long press "K3" automatic/manual | ⑦ Long press "K2" to switch LCD+TP/LCD | ⑧ Press "K1" brightness cycle long press "K1" recommendation |
| ⑨ 12V power port | ⑩ Device power switch | ⑪ TYPE-C | ⑫ SWD ⑬ UART |

2.2 Connection diagram:

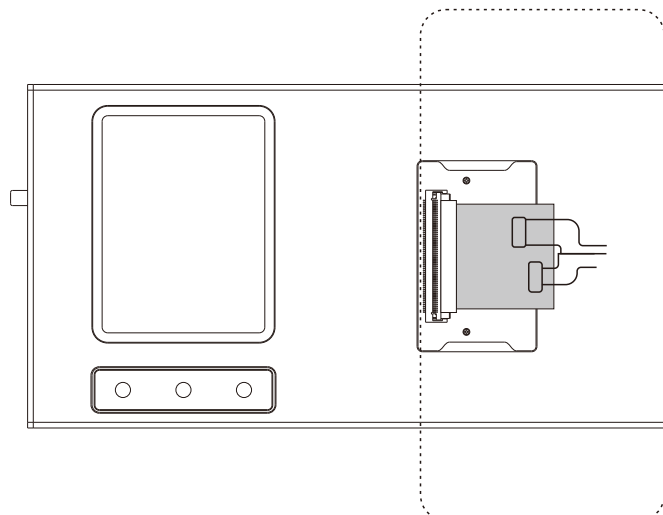

3 M830 test box is turned off

Start:

Plug in the DC power cord and switch "Power Switch" to "ON" to open the M830 test box power supply. equipment

After initializing the internal hardware, the user found that the M830 test box comes with the screen with the screen normally to successfully turn on.

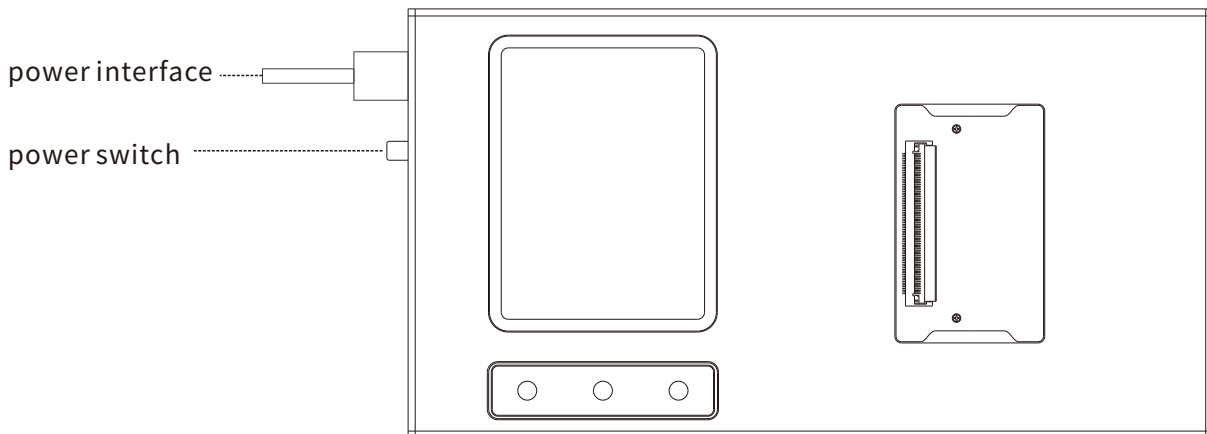

Shutdown: Switch the 'Power Switch' to the 'OFF' state to turn off the power supply of the M830 test box, and then unplug the power cord.

4 Screen display test

Preparation before testing:

- The corresponding adapter board for the 'screen to be tested'
- Transfer cable
- M830 test box

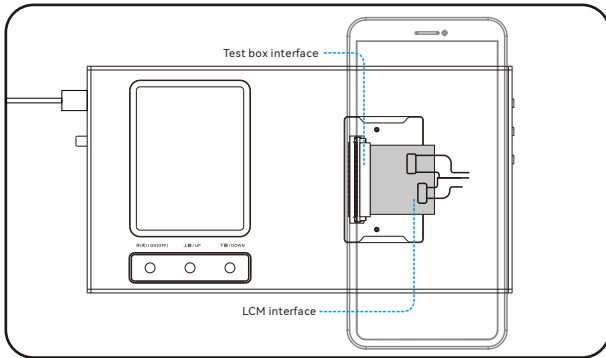

STEP1:'Test screen' connectionThe "screen to be tested" corresponds to the transfer board and transferConnect the cable to the M830 test box.

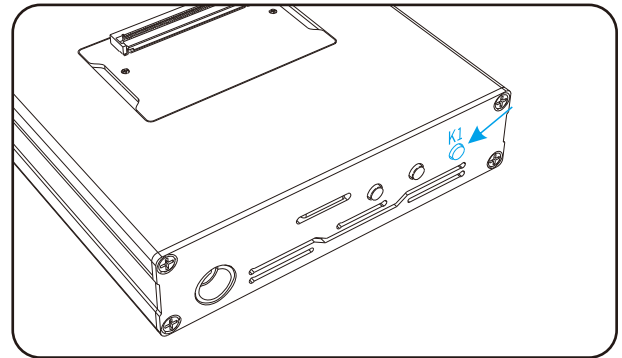

STEP2:Identification program
If the automatic recognition cable is incorrect or not recognized, click the "K1" button to identify the model.

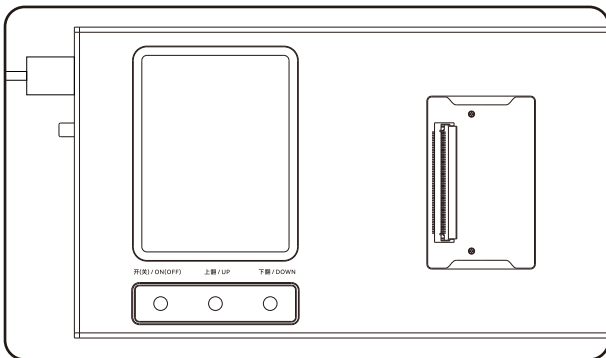

STEP3:Load program
Click the "Switch" button to enter the program selection status. Click "Flip Up, Flip Down" to select the corresponding program, and then click "Switch" to load the program.

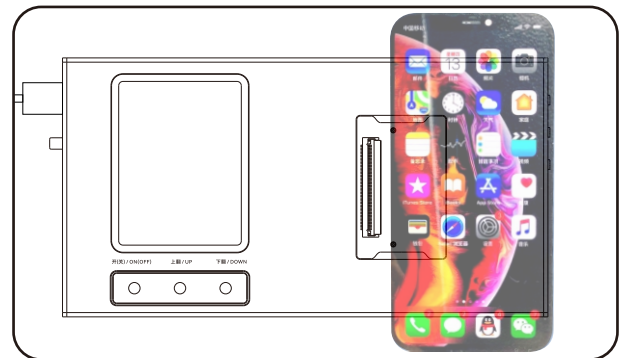

STEP4:Tests Screen
Click the "On/Off" button, light up the screen, and click "Flip Up, Flip Down" to switch to the test screen to see the effect.

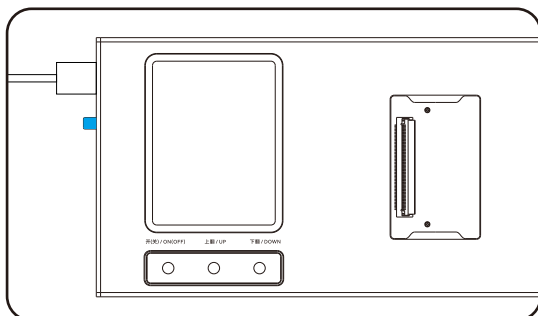

STEP5:Turn off the screen
By flipping the "switch" and switching the switch status to the off state, the screen can be turned off.

Repeat STEP4-STEP5 to continue testing the next piece

5 Touch Scribe Test

Preparation before testing:

- The corresponding adapter board for the 'screen to be tested'
- Transfer cable
- M830 test box

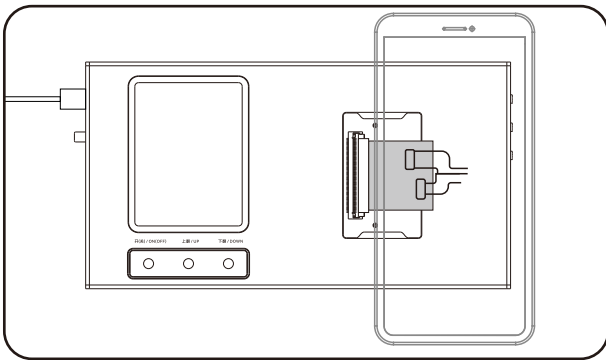

STEP1:The 'screen to be tested' is lit
The 'screen to be tested' is connected to M830 and lit. Click "Flip Up, Flip Down" to switch screens normally.

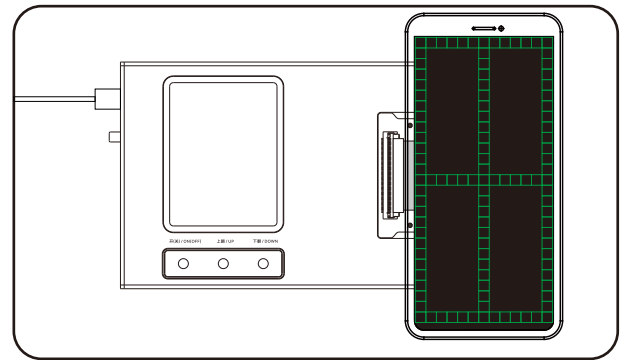

STEP2:Select the touch marking test interface
Click "flip up, flip down" to switch to the touch marking test interface.

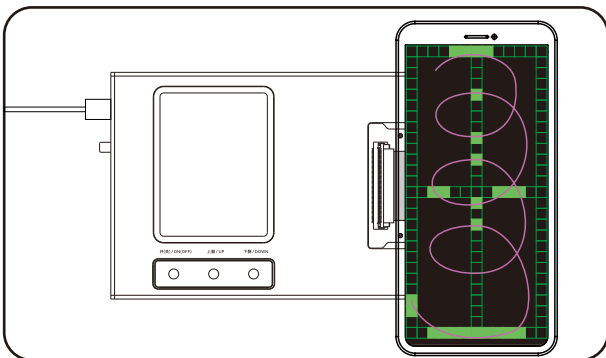

STEP3:Scribe test
Manual scoring test screen function

6 3D-Touch Function Test

Preparation before testing:

- The corresponding adapter board for the 'screen to be tested'
- Transfer cable
- M830 test box

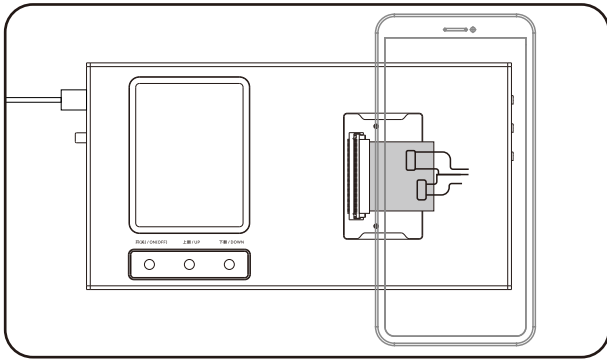

STEP1:The 'screen to be tested' is lit
The 'screen to be tested' is connected to M830 and lit. Click "Flip Up, Flip Down" to switch screens normally.

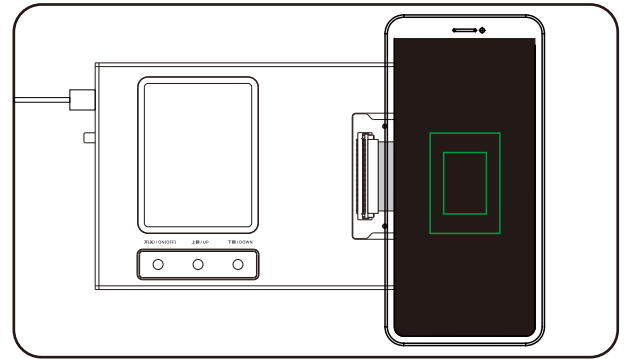

STEP2:Select 3D-Touch testing interface
Click "flip up, flip down" to switch to the 3D-Touch testing interface.

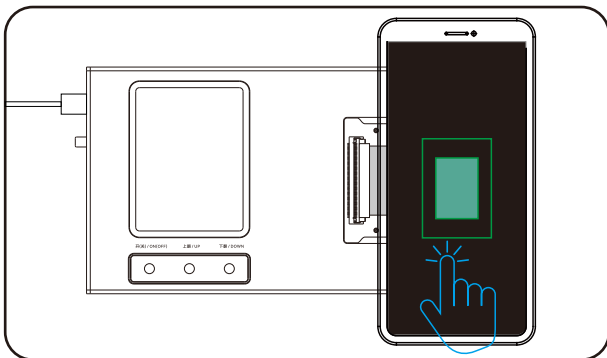

STEP3:Level 1 pressure test
Gently press with your fingers, and the inner frame will display green, indicating a level 1 pressure test

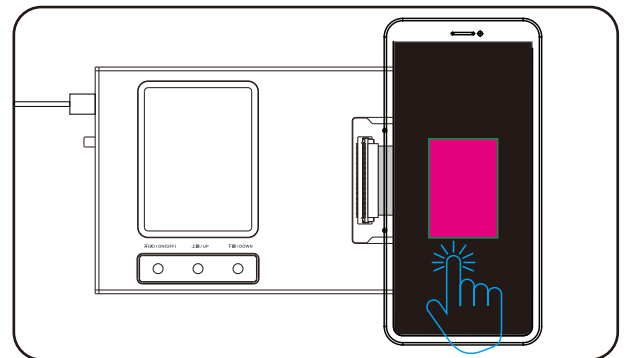

STEP4:Level 2 pressure sensing test
Finger pressure increases, and the inner frame displays red, indicating a level 2 pressure test

7 Screen brightness cycling function

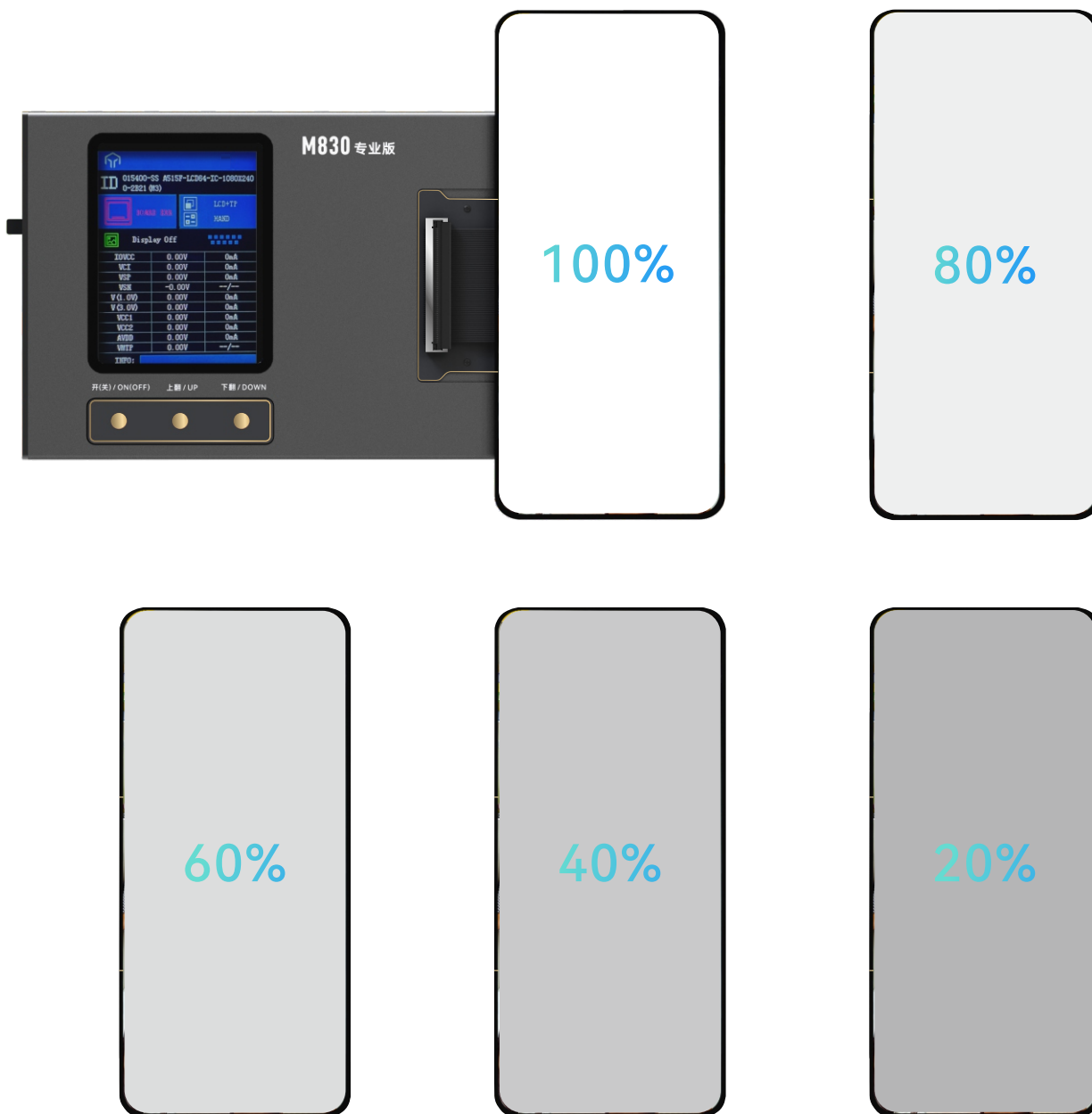

Short press the K1 key to activate the brightness cycle test function

8 Apple Screen Original Color Repair

Preparation before testing:

- The corresponding adapter board for the 'screen to be tested'
- Transfer cable
- M830 test box

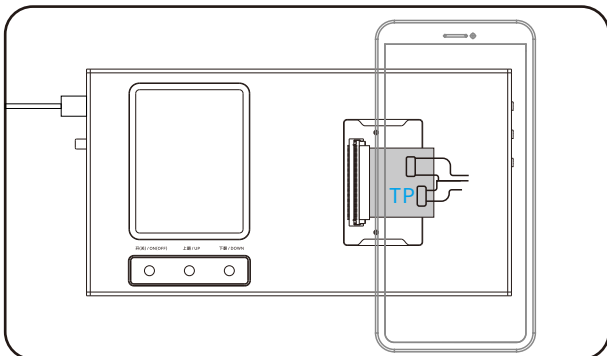

STEP1: 'Test screen' connection

The TP interface of the "screen to be tested" corresponds to the adapter board and is connected to the adapter cable and M830 test box.

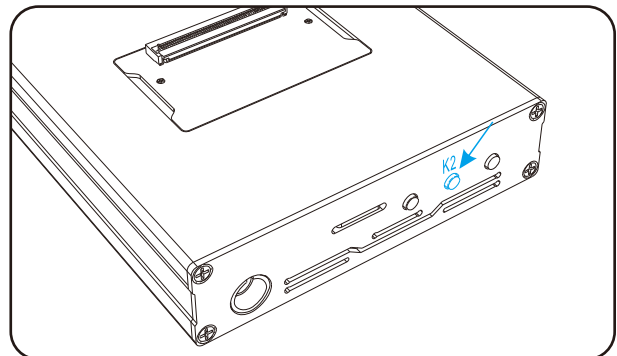

STEP2: Read the original screen color program

Long press the K2 key to switch to the True TONE function. Click the 'flip up' button to read the original color code.

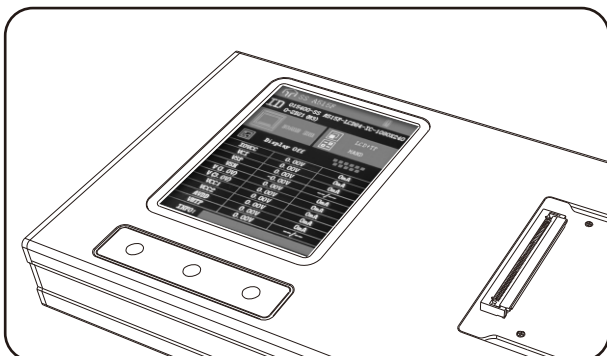

STEP3: Original color program successfully read

Successfully read, will display at the bottom of the screen "Read Original Color OK!"

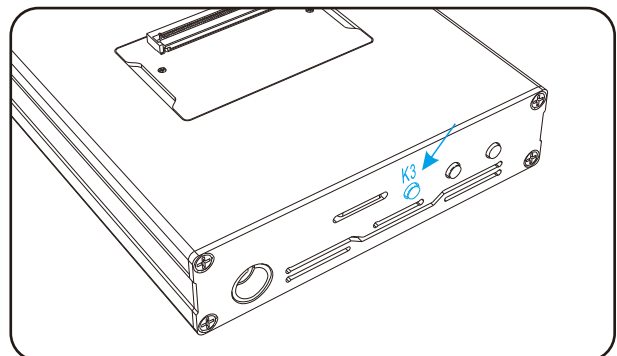

STEP4: Write the original screen color program

Click the "Scroll Down" button to read the original screen color program.

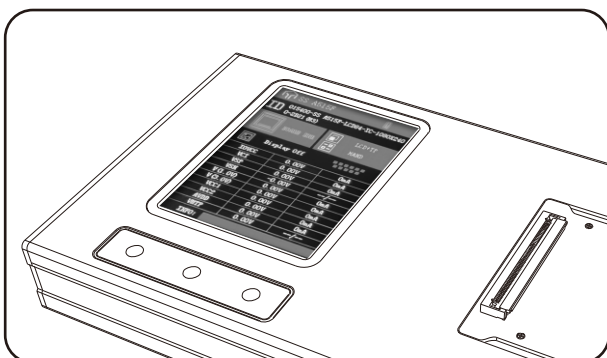

STEP5: Original color program successfully written

Successfully burned, will display at the bottom of the screen "Write Original Color OK!"

9 app online upgrade function

Yuchengxing Assistant app online upgrade: installation package acquisition

1. Store in the machine SD card, copy the installation package to the computer through the card reader.
2. Let customer service staff send installation packages.
3. Download on the server network disk, address: <http://quickconnect.cn/ycx> account number: GS001 password: CY666888

After the installation is complete, enter the account number and password login provided by the customer service staff



After the login is successful, connect the computer after the device is turned on, and automatically start to update the program



10 Product specifications and packaging

Product parameters:

Product model: M830

Material: Aluminum alloy

Color: Black

Power supply: DC12V-1.5A

Power interface: DC interface

Working temperature: 25°C~85°C

Working humidity: <90%RH

Product size: 170.2mm*90.8mm*21.7mm

Storage temperature and humidity: -30 °C ~ 85 °C <90%RH



Packaging List:

Accessories details: M830 test box, DC charging cable.*The packaging list listed above is for reference only, please refer to the actual packaging list

11.1 Warranty and Non-warranty Regulations

Warranty Regulations:

- 1.If there is a performance failure of the product within 7 days from the day after you received the product, and it is determined by our after-sales service center, you can enjoy free return or repair service.
- 2.If there is a performance failure of the product within 8-15 days from the day after you received the product, and it is determined by our after-sales service center, you can enjoy free replacement or repair service.
- 3.If there is a performance failure of the product within 1 year from the day after you received the product, and it is determined by our after-sales service center, you can enjoy free repair service.

Non-warranty Regulations:

- 1.Failure caused by consumers' unauthorized disassembly, repair, misuse, modification, or improper storage.
 - 2.Incorrect use of non-product accessories or tearing, altering labels.
 - 3.The warranty period has exceeded the effective period of the "Three Guarantees" policy.
 - 4.Damage caused by natural disasters or force majeure.
 - 5.Use of a non-company provided charger causing damage to the device.
- *To the extent permitted by law, Yuchengxing Electronic Technology Co., Ltd. reserves the right of interpretation

11.2 matters needing attention

- 1.Confirm that the power supply voltage matches the rated voltage of the equipment and then connect the tester
- 2.Please use the original charging cable

Other precautions:

- 1.Do not use this equipment in high temperature and humid environment to avoid reducing the service life of the equipment or causing damage
- 2.The input and output interfaces of the equipment have clear identification and specifications. Do not connect the wrong interface during use
- 3.Do not disassemble the equipment to cause damage to the equipment and affect the test effect
- 4.Please regularly clean the dust and foreign matters accumulated in the equipment for a long time and keep the equipment clean
- 5.Do not subject the product to mechanical impact